

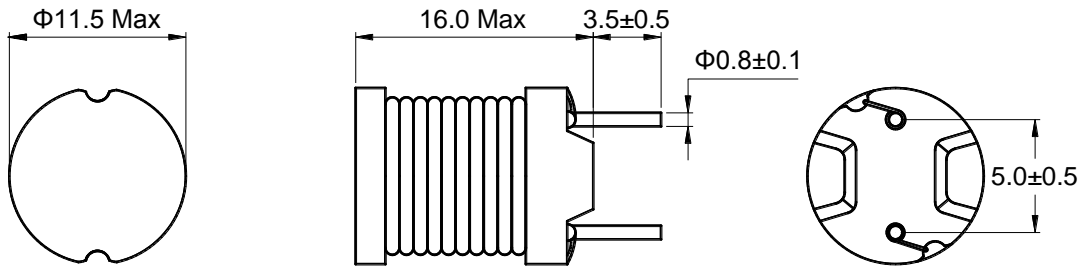

### Outline: 产品概要

- High reliability, high consistency inductance.  
高可靠性，电感值一致性好。
- High saturation current.  
饱和电流高。
- Lead free product, RoHS compliant.  
无铅产品，符合 RoHS 指令。
- Widely used in power supply, DC-DC converter, computer and peripherals, air-condition, home electric appliance, and etc.  
适用于电源，DC-DC 转换器，电脑及其外围设备，空调，家用电器等。
- Operating temperature :  $-40^{\circ}\text{C} \sim +125^{\circ}\text{C}$   
(Including coil's temperature rise)  
工作温度： $-40^{\circ}\text{C} \sim +125^{\circ}\text{C}$  (包含线圈发热)

### 1 Appearance and dimensions (mm) 外形尺寸



### 2 Marking 印字标识



※ Marking is available if needed.  
如果需要，产品可印字。

### 3 Reference hole pattern (mm) 参考焊孔尺寸

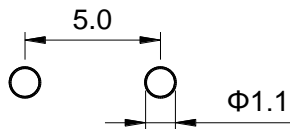

### 4 Schematic 原理图

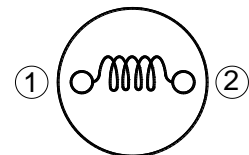

**5 Electrical characteristics**

**电气特性**

Part No. 型号	Inductance (μH) (1-2)/(3-4) 电感值 ※1 ±10%	D.C.R. (mΩ) (1-2)/(3-4) 直流电阻		Saturation current (A) (1-2)/(3-4) 饱和电流 ※2 Max
		Typical	Max	
PKS1014-100K	10.0	23.0	27.6	4.00
PKS1014-220K	22.0	36.0	43.2	3.30
PKS1014-470K	47.0	58.0	69.6	2.50
PKS1014-101K	100	100	120	1.70
PKS1014-221K	220	245	294	1.20
PKS1014-471K	470	455	546	0.84
PKS1014-102K	1,000	1,120	1,340	0.52
PKS1014-222K	2,200	2,240	2,690	0.32
PKS1014-472K	4,700	5,180	6,220	0.23
PKS1014-103K	10,000	11,200	13,400	0.16
PKS1014-393K	39,000	40,600	48,700	0.09

■ All data is tested based on 25°C ambient temperature.  
所有数据基于环境温度 25°C条件下测试。

※1 Inductance measure condition at 1kHz, 0.25V.  
电感测试条件为 1kHz, 0.25V。

※2 Saturation current: the actual value of DC current when the inductance decrease 20% of its initial value.  
饱和电流: 电感值下降其初始值的 20%时所加载的实际直流电流值。

※ Special remind: Circuit design, component placement, PWB size and thickness, cooling system and etc. all will affect the product temperature. Please verify the product temperature in the final application.  
特别提醒: 线路设计, 组件布局, 印刷线路板(PWB)尺寸及厚度, 散热系统等均会影响产品温度。请务必在最终应用时, 验证产品发热状况。

**4 Saturation current curve  
饱和电流曲线**

