

Outline: 产品概要

- High reliability, high consistency inductance.
高可靠性，电感值一致性好。
- High saturation current.
饱和电流高。
- Lead free product, RoHS compliant.
无铅产品，符合 RoHS 指令。
- Widely used in power supply, DC-DC converter, computer and peripherals, air-condition, home electric appliance, and etc.
适用于电源，DC-DC 转换器，电脑及其外围设备，空调，家用电器等。
- Operating temperature : -40°C ~ +125°C
(Including coil's temperature rise)
工作温度：-40°C ~ +125°C (包含线圈发热)

1 Appearance and dimensions (mm) 外形尺寸

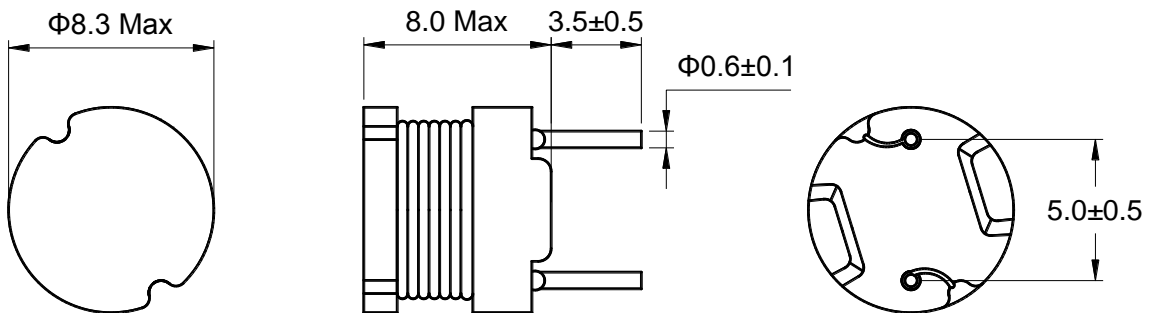

2 Marking 印字标识



3 Reference hole pattern (mm) 参考焊孔尺寸

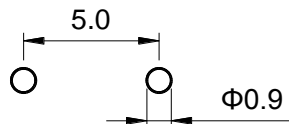

4 Schematic 原理图

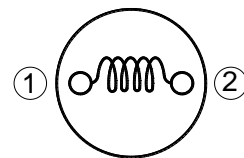

※ Marking is available if needed.
如果需要，产品可印字。

5 Electrical characteristics

电气特性

Part No. 型号	Inductance (μH) 电感值 ※1 ±10%	D.C.R. (mΩ) 直流电阻		Saturation current (A) 饱和电流 ※2 Max
		Typical	Max	
PKS0807-100K	10.0	35.0	42.0	2.90
PKS0807-220K	22.0	63.0	75.6	1.80
PKS0807-470K	47.0	105	126	1.30
PKS0807-101K	100	196	235	0.89
PKS0807-151K	150	294	353	0.72
PKS0807-221K	220	441	529	0.57
PKS0807-331K	330	735	882	0.46
PKS0807-561K	560	1,190	1,430	0.36
PKS0807-102K	1,000	2,060	2,470	0.27
PKS0807-222K	2,200	4,370	5,250	0.18
PKS0807-472K	4,700	11,700	14,000	0.12
PKS0807-103K	10,000	23,100	27,700	0.08

■ All data is tested based on 25°C ambient temperature.
所有数据基于环境温度 25°C条件下测试。

※1 Inductance measure condition at 1kHz, 0.25V.
电感测试条件为 1kHz, 0.25V。

※2 Saturation current: the actual value of DC current when the inductance decrease 20% of its initial value.
饱和电流: 电感值下降其初始值的 20%时所加载的实际直流电流值。

※ Special remind: Circuit design, component placement, PWB size and thickness, cooling system and etc. all will affect the product temperature. Please verify the product temperature in the final application.
特别提醒: 线路设计, 组件布局, 印刷线路板(PWB)尺寸及厚度, 散热系统等均会影响产品温度。
请务必在最终应用时, 验证产品发热状况。

**4 Saturation current curve
饱和电流曲线**

